

# 2017 High Plains Regional Rendezvous

June 18-24, 2017

Bemidji, Minnesota



Join us for a traditional re-enactment of pre-1840's Fur Trade Era camp and events. Set in a scenic Minnesota pine forest near the Headwaters of the Mississippi.

2017 HPRR promises to have competitions, activities, demonstrations, and educational sessions for everyone! Including numerous black powder shooting events; rifle, shot-gun, pistol, trade gun and flintlocks. As well as archery contests, hawk and knife throws, flu-flu shoot, camp games, cooking contests, seminars, and women's and kid's games. Join us in beautiful Northern Minnesota for a top-notch rendezvous you won't soon forget!

## GATE SCHEDULE:

Early set up allowed June 12-16: *Early set up makes you eligible for work parties.*

### Long Term Camp

Gates open for set up. Saturday, June 17, 8:00 a.m. – 5:00 p.m. and Sunday June 18, 8:00 a.m. – 4:00 p.m.

Long term camp closes @ 4:00 p.m. Sunday

### Short Term Camp

Gates open June 19-24, 8:00 -9:00 a.m. and 5:00-6:00 p.m.

### Opening Ceremony

Sunday, June 18, @ 6:00 pm. Loading and Unloading after opening ceremony limited to one hour.

### Closing Ceremony

Saturday, June 24, 1:00 pm

Camp is open to the public 8:00 a.m. – 4:00 p.m. June 17 & 18



The High Plains Regional Rendezvous is a pre-1840 Rendezvous. All camps, accoutrements, clothing and trade goods are required to be representative of those prior to the 1840 Fur Trade Era. Rendezvous participants must be in period clothing, including footwear, to enter and leave camp from June 17 until after closing ceremony.

- **Trade tokens will be awarded as prizes for rendezvous events. All 2017 tokens must be redeemed at the 2017 event.**
- **Food and Fur.** Vendors must meet all state requirements. For Information call the MN FDA at: (612)334-4100 for Food and MN DNR at : (888) 646-6367 for Furs.

**Additional Information regarding the HPRR can be found on the official website at:**  
<http://www.hprr.org/>

**Location: 9179 Beltrami Line Road SW, Bemidji, MN 56601**

From US Hwy 2 in Bemidji, go west on County 7 (Division Street) for 0.9 mi. Turn South (left) on to Becida Road SW for 6.6 mi. Turn East (left) onto Beltrami Line Rd SW (gravel). Proceed 0.2mi. Entrance will be marked. Watch for Signs.

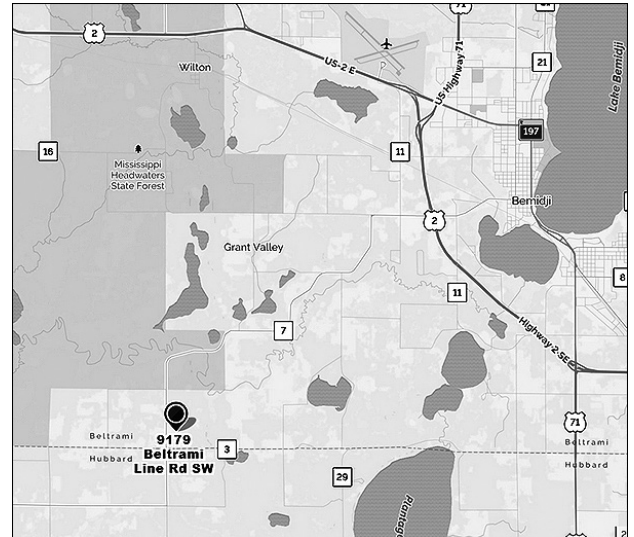

Approximate Distances to Rendezvous site:  
 Minneapolis, MN 220 miles  
 Fargo, ND 120 miles  
 Gary, SD 245 miles  
 Kearney, NE 650 miles  
 Manhattan, KS 700 miles

Booshway: Allison Butterfield  
 (218) 259-2247; hardnocksarrows@gmail.com

Segundo: Al Witthoef  
 (218)841-7096

### REGISTRATION FORM

Name: \_\_\_\_\_  
 Address: \_\_\_\_\_  
 City \_\_\_\_\_ State: \_\_\_\_\_ Zip: \_\_\_\_\_  
 Phone: \_\_\_\_\_ Cell: \_\_\_\_\_  
 Email: \_\_\_\_\_  
 Emergency Contact Name and Phone Number: \_\_\_\_\_

Camp Location Preference: \_\_\_\_\_ Long Term \_\_\_\_\_ Short Term \_\_\_\_\_ Modern \_\_\_\_\_  
 Willing to Help: \_\_\_\_\_ Medical \_\_\_\_\_ Ranges \_\_\_\_\_ Gate \_\_\_\_\_ Demonstration/Seminar \_\_\_\_\_

All early registrations are guaranteed 1 medallion. *Registrations after May 1 or at Gate are not guaranteed a medallion.*

2 Adults and Children under 18 in same tent (Before May 1, 2017) .....	\$60	\$ _____
After May 1, 2017 or at Gate .....	\$65	\$ _____
Additional Adult over 18 in same tent .....	\$15	\$ _____
Additional Structure .....	\$15	\$ _____
Trader's Camp Fee: Trader's camp includes 2 adults and children under 18 in same tent. Traders camp		
includes lodge, fly, shower, and additional structure for trade goods .....	\$80	\$ _____
Additional Medallions (may not be available at gate) .....	\$10	\$ _____
Limited Edition 2017 HPRR Ceramic Mugs.....	\$15	\$ _____

Minnesota welcomes you and would like to invite you to a free camp meal on Saturday evening. We will be serving bison, wild rice, potatoes, mixed vegetable and dinner roll. Come be our guest, but let us know so we can plan accordingly. RSVP for camp meal June 17 # \_\_\_\_\_ attending.

Send Pre-registration form and payment (checks made out to HPRR 2017) to: HPRR c/o Connie Petrie, 6292 Petrie Ct. NW, Bemidji, MN 56601